

24, 36, 48 & 60 Month  
Rent-To-Own Available

QUALITY YOU CAN TRUST



H & S Portable Buildings

Portable Buildings  
Catalog - Winter 2025

# THINGS YOU NEED TO KNOW BEFORE YOU BUY

## Site Preparation

You (The customer) are responsible for leveling blocks. (A great rule to go by is 1 block per foot for 8' and 10' wide buildings, and 2 blocks per foot for 12', 14', and 16' wide buildings) This number can vary depending on how level your site is.

For Buildings elevated to 2 blocks high, double the amount of blocks.

Inadequate blocks may result in voided warranty.



4-in W x 8-in H x 16-in L Concrete Block

## Warranty

Our 5 Year Craftsmanship warranty covers material defects and craftsmanship errors. Normal aging of materials, paint fade, fire or storm damage is excluded. Warranty also does not cover damages occurred after delivery or set up of unit unrelated to the quality or construction of material. Warranty start date is found in the last 6 digits of the serial number. To make a claim, customer must have serial number of unit and also be the original owner or purchaser. H&S Portable Buildings reserves the right to determine if each or all claims are warranty related.

## Permits

**H & S Portable Buildings** is not responsible for any building permits and homeowners association rules and covenants.

Customer will be responsible for obtaining any permits, licenses and right of ways to property.

## Deliveries

Free delivery and set up within 50 miles from any **H & S Portable Buildings** dealer. Over 50 miles, additional mileage charges will apply.

Customer will be responsible for any obstructions including fences, trees, ditches etc. **H & S Portable Buildings, H & S Deliveries, or any associated parties, or companies** are not responsible for any damages to yards, driveways or underground utilities or pipelines. Please allow up to 3-6 weeks to be contacted for delivery on all new order buildings. Buildings with electrical and customization, may take additional time to ensure we provide you with the best quality.



## Rent To Own

Rent to own is available on most units in 24, 36, 48, and 60 month installments with low down payments, no credit check, and a 90 days same as cash option.

# BUILDING FEATURES

- 4x6 Ground Skids Notched and Pressure Treated
- 2x6 Exterior Grade Floor Joists every 16"  
(8' wide buildings have 2x4 exterior grade floor joists every 16")
- 5/8" LP Shed Floor with SmartFinish
- 3/8" LP Smartside Painted or Stained (no additional charge)
- 10-Year Non-Fade Haley Paint Guarantee and a 25-Year Adhesion Promise.
- Premium 2x4 Studs every 16"
- 29 Gauge Steel Roofing with a 40 Year Factory Warranty
- All Ridges are Vented and Screened to Prevent Rodents
- Double Top Plated Walls



## DIMENSIONS

Due to D.O.T. regulations our 12' and 16' wide buildings are labeled with nominal values that are not the exact measurements of the interior or exterior widths.

## BUILDING FLOOR WIDTHS

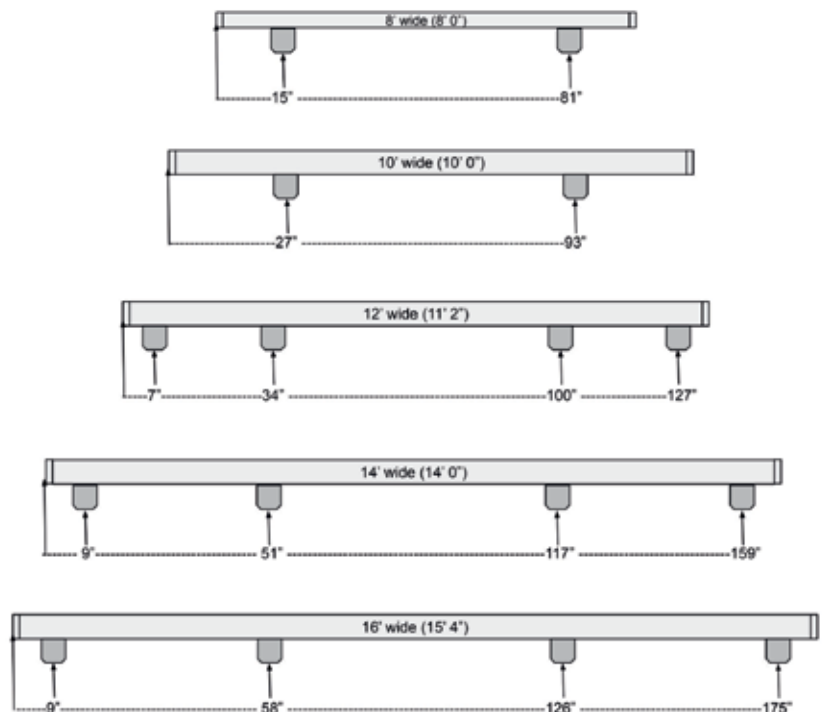

# GREENHOUSES



## Standard Layout

- 16" Single Tier Shelving
- Greenhouse Fan
- Steel-frame Greenhouse Door With Window

Size	Price	RTO 36 mo.
5x8	\$2,425.00	Not Available
<b>5x8: \$410 Delivery Charge Not Included</b>		
8x12	\$3,175.00	\$160.22
10x16	\$4,625.00	\$201.75

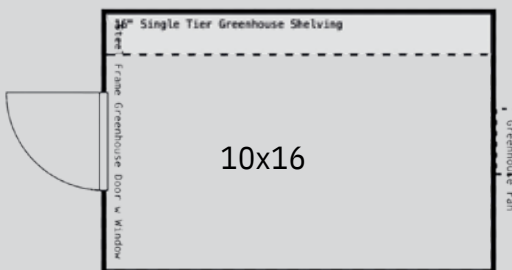
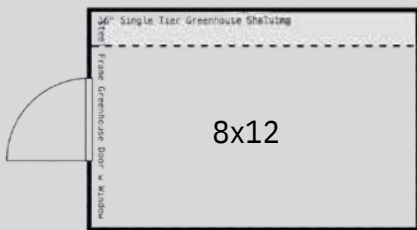
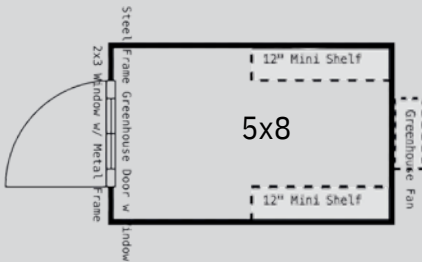

## Add-Ons

- Infrared Greenhouse Heater ..... \$275.00
- Watering and Misting System ..... \$195.00
- 2x3 Window With Metal Frame ..... \$150.00
- Steel-frame Greenhouse Door With Window ..... \$200.00
- GFCI Receptacle ..... \$160.00
- Greenhouse Fan.....\$225.00
- 16" Single Tier Shelving..... \$16.00 Per Foot
- 12" Mini Shelving.....\$15.00 Per Foot

*Lifetime warranty on frame  
5 year warranty on poly  
8x12 & 10x16 only*

# STUDIO SHED



With sleek modern lines and a unique single-slope roof, this structure offers versatility to transform into various spaces such as an art studio, office, home gym, workshop, pool-house, or tranquil she shed.

Colors Pictured:  
Siding - Brook Blue  
Trim - Brook Blue  
Roof - Burnished Slate



## Standard Options (Included)

- 18"x29" Thermal Transom Windows
- 36"x48" Casement (Crank) Windows
- 6" Flush Mount LED Lights
- Active French Doors
- Single Slope Roof

Additional packages and options will be coming soon. For further details, please reach out to your nearest dealer.



Size	Price	RTO 36 mo.
8x12	\$7,765.00	\$359.49
8x16	\$9,345.00	\$432.64
10x12	\$8,345.00	\$386.34
10x16	\$10,025.00	\$464.12
10x20	\$11,455.00	\$530.32
12x16	\$10,645.00	\$492.82
12x20	\$12,225.00	\$565.97
12x24	\$13,765.00	\$637.27
12x28	\$14,995.00	\$694.21
12x32	\$16,395.00	\$759.03
12x36	\$18,285.00	\$759.77
14x20	\$15,985.00	\$740.05
14x24	\$16,925.00	\$783.56
14x28	\$18,495.00	\$764.25
14x32	\$19,895.00	\$794.06
14x36	\$21,655.00	\$831.54
14x40	\$23,275.00	\$866.04

# UTILITY

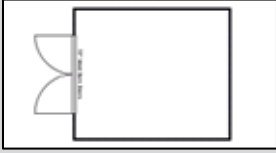

Colors Pictured:  
Siding - Gray  
Trim - White  
Roof - Charcoal



- 6' Wood Double Doors (72" clearance)
- 92" Wall Height
- 8x12 and 10x12 is 80" Wall Height
- 5/12 Roof Pitch

12' Wide Floor Width: 11'2". Eave to eave: 12'  
16' Wide Floor Width: 15'4". Eave to eave: 16'

Size	Price	RTO 36 mo.
8x12	\$2,845.00	\$131.71
8x16	\$3,495.00	\$161.81
10x12	\$3,345.00	\$154.86
10x16	\$4,145.00	\$191.90
10x20	\$4,975.00	\$230.32
12x16	\$4,895.00	\$226.62
12x20	\$5,895.00	\$272.92
12x24	\$6,675.00	\$309.03
12x28	\$7,575.00	\$350.69
12x32	\$8,495.00	\$393.29
12x36	\$9,475.00	\$438.66
14x16	\$6,475.00	\$299.77
14x20	\$7,575.00	\$350.69
14x24	\$8,425.00	\$390.05
14x28	\$9,395.00	\$434.95
14x32	\$10,375.00	\$480.32
14x36	\$11,425.00	\$528.94
14x40	\$12,595.00	\$583.10
16x24	\$9,375.00	\$434.03
16x28	\$10,495.00	\$485.88
16x32	\$11,675.00	\$540.51
16x36	\$12,845.00	\$594.68
16x40	\$14,045.00	\$650.23
16x44	\$14,995.00	\$694.21
16x48	\$15,995.00	\$740.51
16x52	\$16,995.00	\$786.81

# GARDEN SHED

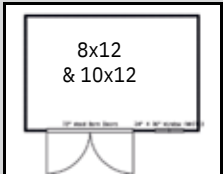

8x12  
& 10x12

Colors Pictured:  
Siding - Clay  
Trim - Light Stone  
Roof - Light Stone



Colors Pictured:  
Siding - Pine Bark  
Trim - Light Stone  
Roof - Galvalume



- (2) 24"x36" Windows
- 6' Wood Double Doors (72" clearance)
- 92" Wall Height
- 5x12 Roof Pitch
- 8x12 and 10x12 Only Include (1) 24" x 36" Window and 80" Wall Height.

12' Wide Floor Width: 11'2". Eave to eave: 12'  
16' Wide Floor Width: 15'4". Eave to eave: 16'

Size	Price	RTO 36 mo.
8x12	\$2,945.00	\$136.34
8x16	\$3,695.00	\$171.06
10x12	\$3,445.00	\$159.49
10x16	\$4,345.00	\$201.16
10x20	\$5,175.00	\$239.58
12x16	\$5,095.00	\$235.88
12x20	\$6,095.00	\$282.18
12x24	\$6,875.00	\$318.29
12x28	\$7,775.00	\$359.95
12x32	\$8,695.00	\$402.55
12x36	\$9,675.00	\$447.92
14x16	\$6,675.00	\$309.03
14x20	\$7,775.00	\$359.95
14x24	\$8,625.00	\$399.31
14x28	\$9,595.00	\$444.21
14x32	\$10,575.00	\$489.58
14x36	\$11,625.00	\$538.19
14x40	\$12,795.00	\$592.36
16x24	\$9,575.00	\$443.29
16x28	\$10,695.00	\$495.14
16x32	\$11,875.00	\$549.77
16x36	\$13,045.00	\$603.94
16x40	\$14,245.00	\$659.49
16x44	\$15,195.00	\$703.47
16x48	\$16,195.00	\$749.77
16x52	\$17,195.00	\$796.06

# LOFTED BARN

Size	Price	RTO 36 mo.
8x12	\$3,375.00	\$156.25
8x16	\$4,175.00	\$193.29
10x12	\$3,825.00	\$177.08
10x16	\$4,805.00	\$222.45
10x20	\$5,815.00	\$269.21
12x16	\$5,535.00	\$256.25
12x20	\$6,575.00	\$304.40
12x24	\$7,455.00	\$345.14
12x28	\$8,445.00	\$390.97
12x32	\$9,195.00	\$425.69
12x36	\$10,545.00	\$488.19
14x16	\$7,395.00	\$342.36
14x20	\$8,525.00	\$394.68
14x24	\$9,525.00	\$440.97
14x28	\$10,625.00	\$491.90
14x32	\$11,945.00	\$553.01
14x36	\$12,995.00	\$601.62
14x40	\$14,375.00	\$665.51
14x44	\$15,755.00	\$729.40
14x48	\$17,125.00	\$792.82



\*Shown with lap siding upgrade



Colors Pictured:  
Siding - Garland Green  
Trim - Gray  
Roof - Galvalume

- 6' Wood Double Doors (72" clearance)
- (2) 4' Loft Sections
- 80" Wall Height

12' Wide Floor Width: 11'2". Eave to eave: 12'

# SIDE LOFTED BARN

Size	Price	RTO 36 mo.
8x12	\$3,475.00	\$160.88
8x16	\$4,375.00	\$202.55
10x12	\$3,925.00	\$181.71
10x16	\$5,005.00	\$231.71
10x20	\$6,015.00	\$278.47
12x16	\$5,735.00	\$265.51
12x20	\$6,775.00	\$313.66
12x24	\$7,655.00	\$354.40
12x28	\$8,645.00	\$400.23
12x32	\$9,395.00	\$434.95
12x36	\$10,745.00	\$497.45
14x16	\$7,595.00	\$351.62
14x20	\$8,725.00	\$403.94
14x24	\$9,725.00	\$450.23
14x28	\$10,825.00	\$501.16
14x32	\$12,145.00	\$562.27
14x36	\$13,195.00	\$610.88
14x40	\$14,575.00	\$674.77
14x44	\$15,955.00	\$738.66
14x48	\$17,325.00	\$802.08



\*Shown with 30x36 window

Colors Pictured:  
Siding - Clay  
Trim - Black  
Roof - Black

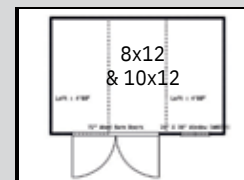

Colors Pictured:  
Siding - Gray  
Trim - Black  
Roof - Black



- (2) 24"x36" Windows
- 6' Wood Double Doors (72" clearance)
- (2) 4' Loft Sections
- 80" Wall Height
- 8x12 & 10x12 Only Include (1) 24" x 36" Window

12' Wide Floor Width: 11'2". Eave to eave: 12'

# GARAGE

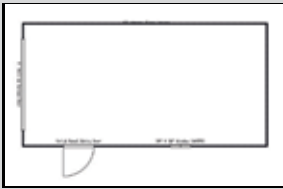

Colors Pictured:  
Siding - Garland Green  
Trim - Brown  
Roof - Brown



- (1) 24"x36" Window
- Standard Size Solid Panel Entry Door
- 10' Wide - 6'x7' Roll Up Door
- 12' Wide - 8'x7' Roll Up Door
- 14' & 16' Wide - 9'x7' Roll Up Door
- Diamond Plated Roll Up Door Threshold
- 92" Wall Height
- 5/12 Roof Pitch
- 2x6 Exterior Grade Floor Joists Every 12"

12' Wide Floor Width: 11'2". Eave to eave: 12'  
16' Wide Floor Width: 15'4". Eave to eave: 16'

Size	Price	RTO 36 mo.
10x12	\$4,395.00	\$203.47
10x16	\$5,215.00	\$241.44
10x20	\$6,065.00	\$280.79
12x16	\$6,050.00	\$280.09
12x20	\$7,070.00	\$327.31
12x24	\$7,870.00	\$364.35
12x28	\$8,800.00	\$407.41
12x32	\$9,740.00	\$450.93
12x36	\$10,750.00	\$497.69
14x16	\$7,675.00	\$355.32
14x20	\$8,805.00	\$407.64
14x24	\$9,685.00	\$448.38
14x28	\$10,685.00	\$494.68
14x32	\$11,685.00	\$540.97
14x36	\$12,765.00	\$590.97
14x40	\$13,965.00	\$646.53
14x44	\$15,165.00	\$702.08
14x48	\$16,365.00	\$757.64
16x24	\$10,655.00	\$493.29
16x28	\$11,805.00	\$546.53
16x32	\$13,025.00	\$603.01
16x36	\$14,225.00	\$658.56
16x40	\$15,455.00	\$715.51
16x44	\$16,435.00	\$760.83
16x48	\$17,465.00	\$808.56
16x52	\$18,505.00	\$764.46

# LOFT BARN GARAGE

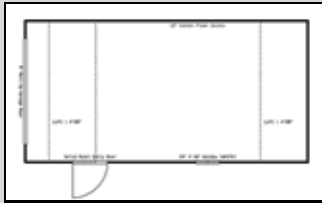

Colors Pictured:  
Siding - White  
Trim - White  
Roof - Black



- (1) 24"x36" Window
- 36"x73" Solid Panel Entry Door
- 10' Wide - 6'x7' Roll Up Door (6'6" height clearance)
- 12' Wide - 8'x7' Roll Up Door (6'6" height clearance)
- 14' Wide - 9'x7' Roll Up Door (6'6" height clearance)
- Diamond Plated Roll Up Door Threshold
- 80" Wall Height
- 2x6 Exterior Grade Floor Joists Every 12"
- (2) 4' Loft Sections

12' Wide Floor Width: 11'2". Eave to eave: 12'

Size	Price	RTO 36 mo.
10x12	\$4,875.00	\$225.69
10x16	\$5,875.00	\$271.99
10x20	\$6,905.00	\$319.68
12x16	\$6,690.00	\$309.72
12x20	\$7,750.00	\$358.80
12x24	\$8,650.00	\$400.46
12x28	\$9,670.00	\$449.79
12x32	\$10,440.00	\$483.33
12x36	\$11,820.00	\$547.22
14x16	\$8,595.00	\$397.92
14x20	\$9,755.00	\$451.62
14x24	\$10,785.00	\$499.31
14x28	\$11,915.00	\$551.62
14x32	\$13,255.00	\$613.66
14x36	\$14,335.00	\$663.66
14x40	\$15,745.00	\$728.94
14x44	\$17,155.00	\$794.21
14x48	\$18,555.00	\$760.89



# CABIN

Size	Price	RTO 36 mo.
8x16	\$4,295.00	\$198.84
10x16	\$4,995.00	\$231.25
10x20	\$5,755.00	\$266.44
12x16	\$5,725.00	\$265.05
12x20	\$6,675.00	\$309.03
12x24	\$7,475.00	\$346.06
12x28	\$8,395.00	\$388.66
12x32	\$9,275.00	\$429.40
12x36	\$10,275.00	\$475.69
14x16	\$7,395.00	\$342.36
14x20	\$8,515.00	\$394.21
14x24	\$9,355.00	\$433.10
14x28	\$10,325.00	\$478.01
14x32	\$11,315.00	\$523.84
14x36	\$12,355.00	\$571.99
14x40	\$13,455.00	\$622.92
14x44	\$14,575.00	\$674.77
14x48	\$15,695.00	\$726.62
16x24	\$10,425.00	\$482.64
16x28	\$11,545.00	\$534.49
16x32	\$12,745.00	\$590.05
16x36	\$13,965.00	\$646.53
16x40	\$15,195.00	\$703.47
16x44	\$16,195.00	\$749.77
16x48	\$17,225.00	\$797.45
16x52	\$18,275.00	\$846.06

Colors Pictured:  
Siding - Garland Green  
Trim - Clay  
Roof - Clay  
Porch - Wellington Brown



Colors Pictured:  
Siding - Gray  
Trim - White  
Roof - Galvalume  
Porch - Bellair Gray



Colors Pictured:  
Siding - Gray  
Trim - White  
Roof - Galvalume  
Porch - Napa Wine

- (3) 24"x36" Windows
- Standard Size 9-lite Entry Door
- Factory Stained 4' Porch
- Hand Rails
- 92" Wall Height
- 5/12 Roof Pitch

12' Wide Floor Width: 11'2". Eave to eave: 12'  
16' Wide Floor Width: 15'4". Eave to eave: 16'

# DUTCH CABIN

Size	Price	RTO 36 mo.
12x24	\$8,315.00	\$384.95
12x28	\$9,195.00	\$425.69
12x32	\$10,115.00	\$468.29
12x36	\$11,125.00	\$515.05
14x24	\$10,195.00	\$471.99
14x28	\$11,195.00	\$518.29
14x32	\$12,195.00	\$564.58
14x36	\$13,245.00	\$613.19
14x40	\$14,325.00	\$663.19
14x44	\$15,445.00	\$715.05
14x48	\$16,575.00	\$767.36
16x24	\$11,295.00	\$522.92
16x28	\$12,345.00	\$571.53
16x32	\$13,545.00	\$627.08
16x36	\$14,755.00	\$683.10
16x40	\$15,975.00	\$739.58
16x44	\$16,995.00	\$786.81
16x48	\$17,995.00	\$833.10
16x52	\$18,995.00	\$879.40

Colors Pictured:  
Siding - Charcoal  
Trim - Light Stone  
Roof - Clay  
Porch - Bellair Gray

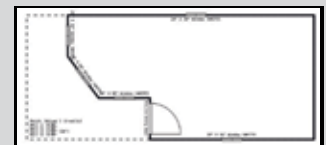

- (5) 24"x36" Windows
- Standard Size 9-lite Entry Door
- Factory Stained Dutch Style Porch
- Hand Rails
- 92" Wall Height
- 5/12 Roof Pitch

12' Wide Floor Width: 11'2". Eave to eave: 12'  
16' Wide Floor Width: 15'4". Eave to eave: 16'

# LOFTED BARN CABIN

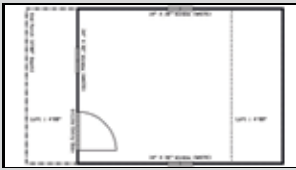

Colors Pictured:  
 Siding - Garland Green  
 Trim - White  
 Roof - Galvalume  
 Porch: Natural



- (3) 24"x36" Windows
- 36"x73" 9-lite Entry Door
- Factory Stained 4' porch
- Hand Rails
- 80" Wall Height
- (2) 4' Loft Sections

12' Wide Floor Width: 11'2". Eave to eave: 12'

Size	Price	RTO 36 mo.
8x16	\$4,905.00	\$227.08
10x16	\$5,635.00	\$260.88
10x20	\$6,535.00	\$302.55
12x16	\$6,395.00	\$296.06
12x20	\$7,365.00	\$340.97
12x24	\$8,405.00	\$389.12
12x28	\$9,305.00	\$430.79
12x32	\$9,955.00	\$460.88
12x36	\$11,425.00	\$528.94
14x16	\$8,375.00	\$387.73
14x20	\$9,465.00	\$438.19
14x24	\$10,505.00	\$486.34
14x28	\$11,825.00	\$547.45
14x32	\$12,925.00	\$598.38
14x36	\$14,265.00	\$660.42
14x40	\$15,575.00	\$721.06
14x44	\$16,935.00	\$784.03
14x48	\$18,275.00	\$846.06

# DUTCH LOFTED BARN CABIN



Colors Pictured:  
 Siding - Pine Bark  
 Trim - Black  
 Roof - Black  
 Porch: Natural



Size	Price	RTO 36 mo.
12x24	\$9,295.00	\$430.32
12x28	\$10,225.00	\$473.38
12x32	\$10,895.00	\$504.40
12x36	\$12,415.00	\$574.77
14x24	\$11,495.00	\$532.18
14x28	\$12,845.00	\$594.68
14x32	\$13,975.00	\$646.99
14x36	\$15,375.00	\$711.81
14x40	\$16,695.00	\$772.92
14x44	\$17,995.00	\$833.10
14x48	\$19,295.00	\$893.29

- (5) 24"x36" Wndows
- 36"x73" 9-lite Entry Door
- Factory Stained Dutch Style Porch
- Hand Rails
- 80" Wall Height
- (1) 12' Loft & (1) 4' Loft Section

12' Wide Floor Width: 11'2". Eave to eave: 12'

# ULTRA SERIES

Size	Price	RTO 36 mo.
8x12	\$3,355.00	\$169.30
8x16	\$3,995.00	\$201.60
10x12	\$4,045.00	\$204.12
10x16	\$4,895.00	\$247.02
10x20	\$5,825.00	\$293.95
12x16	\$5,495.00	\$277.30
12x20	\$6,545.00	\$330.28
12x24	\$7,425.00	\$374.69
12x28	\$8,375.00	\$422.63
12x32	\$9,325.00	\$470.56
12x36	\$10,395.00	\$524.56
<b>5/12 pitch roof</b>		
14x24	\$9,545.00	\$481.67
14x28	\$10,395.00	\$524.56
14x32	\$11,425.00	\$576.54
14x36	\$12,595.00	\$635.58
14x40	\$13,745.00	\$693.61
14x44	\$14,595.00	\$736.50
14x48	\$15,695.00	\$792.02
14x52	\$16,795.00	\$847.53

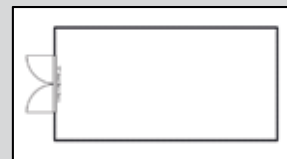

Colors Pictured:  
Siding - Gray  
Trim - White  
Roof - Gray

- 6' Wood Double Doors (72" clearance)
- 92" Wall Height
- 7/12 Roof Pitch
- 8" Overhang on Eaves and Gable

12' Wide Floor Width: 11'2". Eave to eave: 12'

# ELITE SERIES

Size	Price	RTO 36 mo.
8x12	\$5,115.00	\$258.12
8x16	\$5,755.00	\$290.42
10x12	\$5,885.00	\$296.97
10x16	\$6,735.00	\$339.87
10x20	\$7,665.00	\$386.80
12x16	\$7,415.00	\$374.19
12x20	\$8,465.00	\$427.17
12x24	\$9,345.00	\$471.58
12x28	\$10,295.00	\$519.52
12x32	\$11,245.00	\$567.45
12x36	\$12,315.00	\$621.45
<b>5/12 pitch roof</b>		
14x24	\$11,545.00	\$582.59
14x28	\$12,395.00	\$625.49
14x32	\$13,425.00	\$677.47
14x36	\$14,595.00	\$736.50
14x40	\$15,745.00	\$794.54
14x44	\$16,595.00	\$837.44
14x48	\$17,695.00	\$892.94
14x52	\$18,795.00	\$839.99



Colors Pictured:  
Siding - White  
Trim - Black  
Roof - Black  
Shutters & Flower boxes - Chestnut

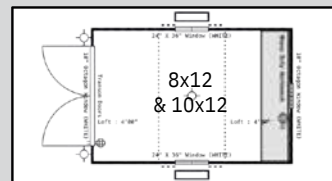

- 6' Wood Double Doors with Transom Windows (72" clearance)
- (2) 24"x36" Windows
- (2) Sets of Z-style Shutters
- (2) Painted Flower Boxes
- (2) Octagon Windows
- (2) Exterior Lamps (with switch)
- Deluxe Electrical Package
- (2) 4' Loft Sections
- Heavy Duty Workbench
- 7/12 Roof Pitch
- 8" Overhang on Eaves and Gable
- 92" Wall Height

12' Wide Floor Width: 11'2". Eave to eave: 12'

# ECONOMY METAL UTILITY

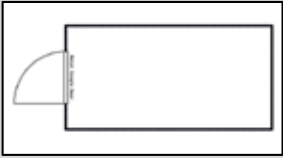

Colors Pictured:  
Siding - White  
Trim - Charcoal  
Roof - Charcoal



Colors Pictured:  
Siding - Charcoal  
Trim - Burnished Slate  
Roof - Burnished Slate



Size	Price	RTO 36 mo.
8x12	\$2,395.00	\$110.88
8x16	\$3,075.00	\$142.36
10x12	\$2,955.00	\$136.81
10x16	\$3,595.00	\$166.44
10x20	\$4,375.00	\$202.55
12x16	\$4,175.00	\$193.29
12x20	\$4,995.00	\$231.25

- 8' Wide comes with 4' Single Door
- 10' Wide and 12' Wide come with 6' Double Door
- 69" Wall Height
- Premium 2x4 Studs every 24"
- 2x6 Exterior Grade Floor Joists every 16"
- 8x12 has 2x4 Exterior Grade Floor Joists every 16"

## DOG KENNELS

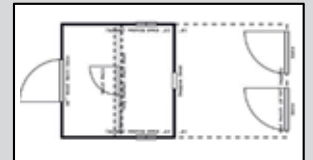

**Single Dog Kennel - \$4,595**

8x16, 2 gates, 1 doggie door, 1 entry door, 2 windows

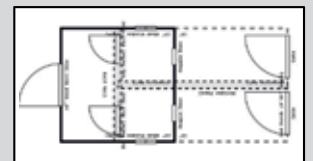

**Double Dog Kennel - \$4,875**

8x16, 2 gates, 2 doggie doors, 1 entry door, 2 windows,  
1 divider wall

*Custom Sizes Available - Call for Pricing*

# EXTERIOR UPGRADES

- Lap Siding.....Ask Dealer For Pricing
- Shingles.....Add 4% of Base Model Price
- Painted Shutters.....\$50.00/pair
- 18" Painted Flower Box.....\$50.00 each
- 24" Painted Flower Box.....\$60.00 each
- 36" Painted Flower Box.....\$70.00 each
- Vertical Metal.....Ask Dealer For Pricing
- 12" Center Floor Joists.....\$0.50/sq.ft.
- Additional Porch Space.....\$50.00/ft.
- 10 Lite Shed Dormer.....\$900.00
- 15 Lite Shed Dormer.....\$1,075.00
- 20 Lite Shed Dormer.....\$1,295.00
- Any Color Option on Barn Doors.....\$40.00
- Wainscot.....\$4.00/ft.
- Air cond/window Cutout.....\$75.00/frame
- Door Frame Out.....\$50.00/frame
- On-site Fee.....18% (Subject to location)
- Custom Colors.....Customer Provides Paint

Lap Siding



Exterior Lamps



Painted Z-Style Shutters



Dormers



Painted Flower Box



Wainscot



# DOORS

9-Lite  
Fiberglass Door



**\$525.00**

Solid Panel  
Fiberglass Door



**\$475.00**

Active Full-light  
Fiberglass French Door

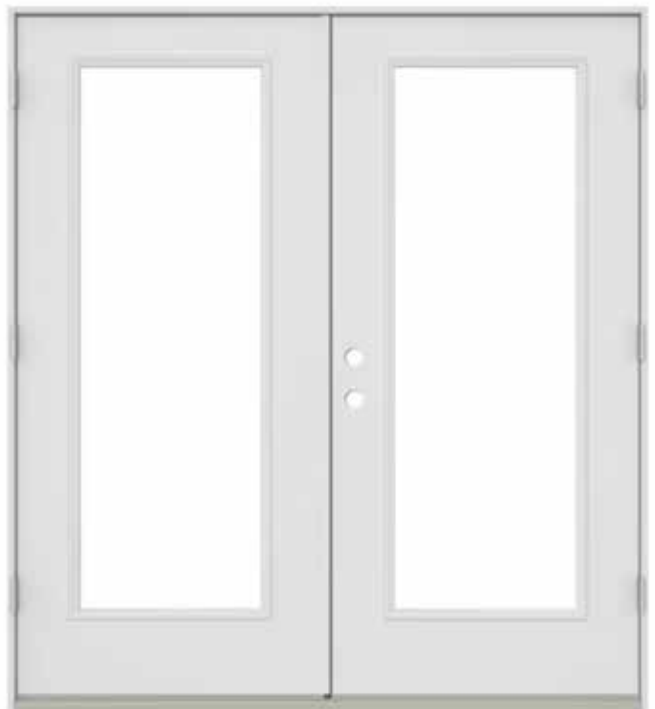

**\$1,195.00**

Barn Doors



Single 36" - **\$125**  
Double 72" - **\$200**

Roll Up Garage Door



6x7 - **\$700**  
8x7 - **\$765**  
9x7 - **\$800**

# WINDOWS

## White Windows



- 18x23.....**\$80.00**
- 24x36.....**\$100.00**
- 30x36.....**\$120.00**

### Thermal

- 24x36.....**\$225.00**
- 32x36.....**\$295.00**
- 36x48.....**\$375.00**
- 36x60.....**\$395.00**

## 18" Octagon Window



**\$100.00**

## Black Windows



- 24x36.....**\$129.00**

### Thermal

- 24x36.....**\$359.00**
- 30x36.....**\$379.00**
- 36x48.....**\$429.00**

## 36"x48" Casement Windows



**\$495.00**

## Transom Windows 29"x10"



White - **\$50.00**



Black - **\$64.00**

## 18"x29" Transom Window

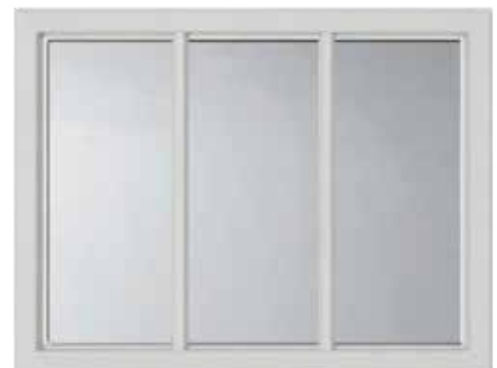

**\$195.00**

# SIDE SHEDS



- 7' Depth X Length of Building
- Anchored During Setup
- Not Available on Lofted Models, Economy Metals, or 80" walls

**Ask Dealer For Pricing**



# RAMPS

R-200 Two Piece Adjustable Ramp....\$250.00

R-300 Three Piece Adjustable Ramp...\$350.00

Stained Ramp Upgrade.....\$95.00

Removable Individual Sections are 21"x66"  
Constructed with pressure treated 2x8 boards





# INTERIOR UPGRADES

- 2-tier shelving.....\$12.00/ft.
- 3-tier shelving.....\$15.00/ft.  
*16" shelf depth, 17.5" shelf height*
- Heavy Duty workbench.....\$12.00/ft.  
*20" workbench depth*
- Additional loft space.....\$5.00/sq.ft.
- Interior Wall Framing .....\$15.00/ft.

3-Tier Shelving



Heavy Duty Workbench



# SPRAY FOAM INSULATION

## Closed Cell Spray Foam

**\$2.85 bd/ft.**



- Weather Resistant
- Fire Resistant
- Pest & Mold Resistant
- Excellent Thermal Barrier
- Adds Structural Integrity

Available for Walls, Roof, and Floor

# ELECTRICAL PACKAGES

**Standard Package.....\$320.00**

Includes 1 light, 1 outlet, 1 switch/outlet combo

*\$75.00 each for any additional lights up to (7) total.*

**Deluxe Package.....\$395.00**

Includes 2 lights, 1 outlet, 1 switch/outlet combo,

*\$75.00 each for any additional lights up to (7) total.*

**Basic Package.....\$245.00**

Includes 1 light, 1 switch/outlet combo.

## Package Add-Ons

100 AMP Load Center Breaker Box.....\$260.00

200 AMP Load Center Breaker Box.....\$375.00

Switch/Outlet combo.....\$110.00

110 Receptacle (plus breaker box purchase).....\$75.00

220 Receptacle (plus breaker box purchase).....\$145.00

Exterior Lamp (each / switch included).....\$115.00

Motion Light.....\$175.00

Flush Mount LED Lights.....\$119.00

# ROOF / METAL COLORS



Black



Brown



Burgundy



Burnished Slate



Barn Red

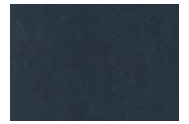

Charcoal



Ivory



Clay



Forest Green



Gallery Blue



Patriot Red



Mocha Tan



Hawaiian Blue



Galvalume



Lightstone



White



Gray



\*Copper



Colony Green



Buckskin



Charcoal Shingle



Weathered Wood Shingle



Barkwood Shingle

# SIDING / TRIM / DOOR COLORS



Black



Dark Brown



Wild Grasses



Burnished Slate



Barn Red



Zook Gray



Pequea Green



Navajo White



GP Clay



Reihl Green

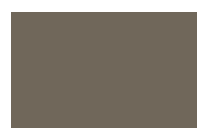

Shale



Pinnacle Red



Buckskin



Avocado



Wedgewood Blue



New Holland Beige

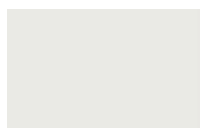

White



Deep Ocean



Bronze

# STAINED WOOD COLORS



Chestnut



Weathered Grey

\*Stained trim must match siding\*

\*Actual Colors May Vary

\*Additional charges may apply for Copper.

\*Custom colors available if customer provides paint.

## Porch Only Stains



Napa-Wine  
(porch only)



Cedar  
(porch only)



Wellington Brown  
(porch only)



Bellair Gray  
(porch only)

# OUR COMMITMENT

**H & S Portable Buildings** is committed to serving you. We use all top quality products and materials.

We value quality craftsmanship as much as you do.  
All our buildings are inspected before they get delivered to ensure you are getting the quality you deserve.

**We value your feedback. Let us know how we are doing at [hsportablebuildings.com](http://hsportablebuildings.com) or on Facebook at H & S Portable Buildings.**



H & S Portable Buildings

**BUILDING EXCELLENCE  
DELIVERING SATISFACTION**



Questions or additional information email [handsportable@gmail.com](mailto:handsportable@gmail.com)

**[hsportablebuildings.com](http://hsportablebuildings.com)**

**WARRANTY CALL (256) 462-1331**

# Dealer Information

Scan the code to  
design your shed!



Visit our website at [www.hsportablebuildings.com](http://www.hsportablebuildings.com)  
to customize your building today  
453 Joe Dutton Rd., Danville, AL 35619  
256-462-1331