



HS HARMONY —STRUCTURES—

**PORTABLE STORAGE BUILDINGS,
CABINS, GARAGES**



- VISION STATEMENT -

We are committed to uphold the love, crossbearing, and Spirit of our Risen Lord. We will strive to be a preferred employer in the community.

- MISSION STATEMENT -

Maintaining our core values, while producing portable buildings that fit your need and last a lifetime.

- PURPOSE STATEMENT -

Our purpose is to develop our team into tomorrows significant leaders, in business, churches, and families. Resulting in a stronger community and nation.

- ABOUT US -

We are the former builders for Bennett Spring Building Center. We have stepped out on our own. Our goal is to produce a portable building that fits your needs and lasts a lifetime.

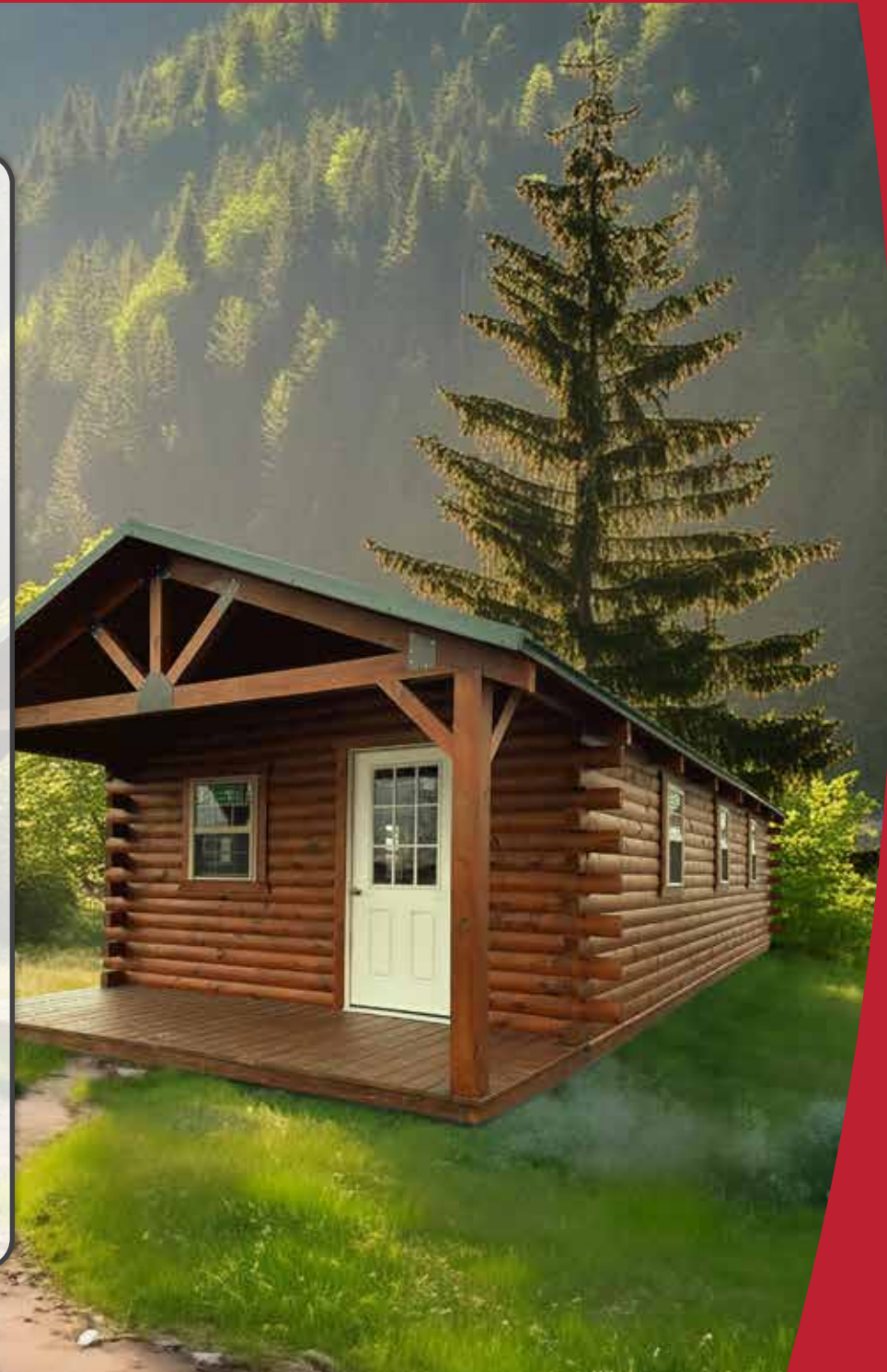

Own Your Dream Building Today with Harmony Structures!

Discover the Benefits of Rent-to-Own



For buildings up to \$15,000, the first month's rent is due upfront at purchase.



For buildings valued between \$15,000 and \$25,000, a 10% down payment is required at purchase.



For purchases over \$25,000, please call for details.



- ✓ Flexible, Affordable, Yours!
- ✓ No Credit Check! Instant Approval!
- ✓ Low Monthly Payments - Start Now!
- ✓ Upgrade Your Space with Zero Hassle!
- ✓ Move In Today, Pay As You Go!
- ✓ Easy Terms, No Hidden Fees!
- ✓ Secure Your Building Now - It's That Simple!
- ✓ From Storage Sheds to Workshops - Own It All!
- ✓ Discover the **FREEDOM** of Rent-to-Own with Harmony Structures. Transform your space today!

FINANCE PRICE	36 MO.	60 MO.
\$3,000.00	\$138.25	\$111.11
\$4,000.00	\$184.33	\$148.15
\$5,000.00	\$230.41	\$185.19
\$6,000.00	\$276.50	\$222.22
\$7,000.00	\$322.58	\$259.26
\$8,000.00	\$368.66	\$296.29
\$9,000.00	\$414.75	\$333.33
\$10,000.00	\$460.83	\$370.37
\$11,000.00	\$506.91	\$407.41
\$12,000.00	\$552.99	\$444.44
\$13,000.00	\$599.08	\$481.48
\$14,000.00	\$645.16	\$518.52
\$15,000.00	\$691.24	\$555.56
\$16,000.00	\$737.32	\$592.59
\$17,000.00	\$783.41	\$629.63
\$18,000.00	\$829.49	\$666.67
\$19,000.00	\$875.58	\$703.70
\$20,000.00	\$921.66	\$740.74
\$21,000.00	\$967.74	\$777.78
\$22,000.00	\$1,013.82	\$814.81
\$23,000.00	\$1,059.90	\$851.85
\$24,000.00	\$1,105.99	\$888.89
\$24,999.00	\$1,152.03	\$925.89

We also offer 24 and 48 month Rent-to-Own options. Call for details. Rates current as of August 2024.

A-FRAME CABINS

Our A-Frame Cabins are our most popular options, perfect for both weekend getaways and longer stays. With various sizes to fit your needs and numerous customization options, you can create the ideal retreat or home tailored just for you.

Features Include:

- 93.5" sidewalls
- 1 – 36" 9 lite insulated door
- Up to 30': 3 – 2'x3' windows
- 14' & 16' wide x 20' – 30' long:
 - 4 – 2'x3' windows
- 32' and longer: 6 – 2'x3' windows
- See page 20 for more options



SIZE CASH PRICE

See page 3 for Rent-To-Own options

10x16	\$5,170	12x30	\$9,885	16x20	\$9,295	16x50	\$19,020
10x18	\$5,595	12x32	\$11,070	16x24	\$11,070	16x52	\$19,820
10x20	\$5,920	12x36	\$12,320	16x28	\$12,420	16x54	\$20,420
12x14	\$5,820	14x20	\$9,645	16x30	\$12,970	16x56	\$21,170
12x16	\$6,370	14x24	\$10,525	16x32	\$13,920	16x58	\$21,930
12x18	\$6,915	14x28	\$11,410	16x36	\$15,345	16x60	\$22,670
12x20	\$7,300	14x32	\$12,370	16x40	\$16,320		
12x24	\$8,270	14x36	\$13,755	16x44	\$17,420		
12x28	\$9,300	14x40	\$14,970	16x48	\$18,420		

See page 7 for Interior Finished options



INTERIOR UNFINISHED

POPULAR OPTIONAL CONFIGURATIONS:



WAINSCOTING



ROOF DORMER



ROOF DORMER



WOOD PORCH



COMPOSITE PORCH

LOFTED CABINS



Introducing the **Lofted Cabin**, a ready-made structure with a dual appeal: a generously spacious loft and a more budget friendly alternative compared to constructing a cabin onsite. Ideal for a cozy tiny house or a welcoming guest accommodation.

- *Generously Spacious Loft:* Perfect for a comfortable sleeping area or additional storage, the loft maximizes the use of vertical space.
- *Ready-Made Structure:* Our cabins come ready to be placed on your property, so you can start enjoying your new space right away.

Contact Your Local Dealer to Learn More and Schedule Your Delivery!

Features Include:

- 1 – 36" 9 lite insulated door
- Up to 22' long: 3 windows
- 24' – 30' long: 5 windows
- 32' and longer: 7 windows
- 81.5" sidewalls
- Full loft except for access area
- See page 20 for more options

SIZE	CASH PRICE	See page 3 for Rent-To-Own options					
10x16	\$5,915	12x30	\$11,595	14x40	\$16,285	16x48	\$20,495
10x18	\$6,315	12x32	\$12,485	16x24	\$12,265	16x50	\$21,170
10x20	\$6,715	12x36	\$13,785	16x28	\$13,345	16x52	\$22,045
12x16	\$7,375	14x20	\$10,425	16x30	\$14,145	16x54	\$22,720
12x18	\$7,995	14x24	\$11,845	16x32	\$15,395	16x56	\$23,560
12x20	\$8,640	14x28	\$12,825	16x36	\$16,970	16x58	\$24,400
12x24	\$10,335	14x32	\$14,615	16x40	\$18,195	16x60	\$25,240
12x28	\$11,185	14x36	\$15,305	16x44	\$19,345		

See page 7 for Interior Finished options

POPULAR OPTIONAL CONFIGURATIONS:



INTERIOR UNFINISHED



TWIN WINDOW 36" x 48"



PORCH



ROOF DORMER

DELUXE CABINS



Our Deluxe Cabins feature overhangs and a steeper roof for a more residential look and enhanced curb appeal. With numerous customization options, you can create your dream cabin. You dream it, we build it!

POPULAR OPTIONAL CONFIGURATIONS:

Features Include:

- Up to 30' long: 4 – 3'x4' insulated windows
- 32' and longer: 6 – 3'x4' insulated windows and 1 – 2'x3' window
- 93.5" sidewalls
- 1 – 36" 9 lite insulated door
- 12" eaves or maxed to delivery specs
- See page 20 for more options

SIZE **CASH PRICE** See page 3 for Rent-To-Own options

10x16	\$10,570	12x24	\$14,825	14x32	\$17,580
10x18	\$11,085	12x28	\$15,760	14x36	\$19,030
10x20	\$11,650	12x30	\$16,887	14x40	\$20,160
10x24	\$12,955	12x36	\$17,430	14x48	\$23,620
12x16	\$11,040	14x20	\$11,088	14x50	\$24,360
12x18	\$12,420	14x24	\$13,306	14x52	\$25,330
12x20	\$13,800	14x28	\$15,523	14x54	\$26,198

See page 7 for Interior Finished options



WAINSCOTING & DELUXE PORCH



FRENCH DOOR



COMPOSITE PORCH

INTERIOR FINISHED OUT CABINS

Dreaming of a weekend cabin or an Airbnb rental? Look no further! Our turnkey cabins come fully prepared and ready for your appliances. With endless customization options, your perfect retreat is within reach. Enjoy the convenience of having your cabin delivered and ready to go, so you can focus on relaxation and making memories.

Standard Features Include:

- Sprayfoam wall, floor & ceiling
- Electrical & plumbing
- Kitchen with Formica counter tops
- Full bath
- Master bedroom
- Water heater
- Pine carsing walls & ceilings
- Vinyl snap lock floating floor
- Washer and dryer hookup
- Lots of custom options
- Mini split hook up or AC unit

SIZE **CASH PRICE**

See page 3 for Financing options

A-FRAME

12x20	\$24,892
12x24	\$29,290
12x32	\$38,943
14x32	\$44,515
14x40	\$52,350
16x32	\$50,577
16x40	\$58,982
16x48	\$69,490
16x54	\$77,794

LOFTED CABINS

12x20	\$28,819
12x24	\$34,544
12x32	\$44,438
14x32	\$51,539
14x40	\$59,640
16x32	\$56,973
16x40	\$67,560
16x48	\$79,581
16x54	\$88,403

DELUXE

12x20	\$31,392
12x24	\$35,845
12x32	\$45,031
14x32	\$49,725
14x40	\$57,540
14x48	\$68,440
14x54	\$76,658

STUDIO

12x20	\$26,172
12x24	\$30,730
12x32	\$40,703
14x32	\$46,355
14x40	\$54,510
16x32	\$50,577
16x40	\$58,982
16x48	\$69,490
16x54	\$77,794

DOUBLE WIDE

24x24	\$58,206
24x36	\$78,970
28x32	\$81,185
28x40	\$101,775
32x36	\$100,959
32x40	\$114,736
32x48	\$138,129
32x52	\$149,492

Prices are estimates with our standard features. Additional popular options are available. Ask for your custom quote.

Popular Options:

- Multiple Car Siding Options: Eastern Cedar, Western Cedar, Burnt Pine, Barn Wood, and more
- Multiple Flooring Options
- Multiple Counter Top Options
- Bring us your blueprint. We'll build to your specs.
- If you bring it, we install it. You dream it, we build it!

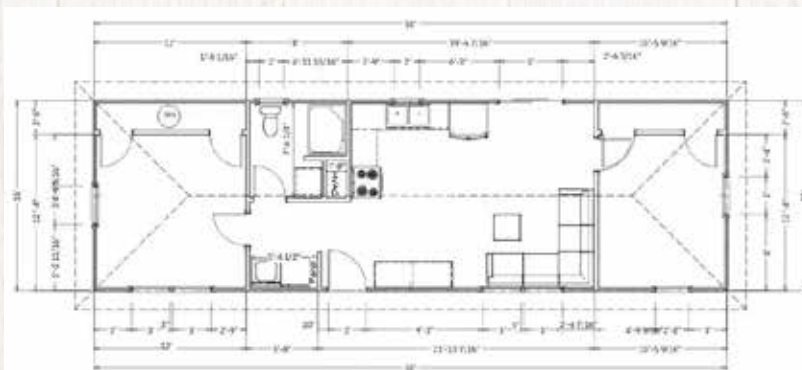

LIVING AREA 720 SQ FT

Example Blueprint



Multiple Interior Options Available

PRICES SUBJECT TO CHANGE WITHOUT NOTICE. CONTACT DEALER FOR DETAILS.

LOG CABINS

D STYLE

Our D Style and Chink Style are our best-selling log cabins making them the perfect choice for campgrounds, Airbnb resorts, and anyone seeking a cozy log cabin retreat. Featuring authentic butt-and-pass log corners, they exude a classic log cabin charm that will delight guests and owners alike. Whether you're creating a memorable vacation spot for visitors or a personal hideaway to unwind, these cabins provide the ideal blend of rustic appeal and modern comfort. Elevate your property and create lasting memories with our versatile and inviting log cabins.

Features Include:

- 30"x36" Clay Windows
- 36" Residential Door
- Each Log is 5.5"x3.5"
- Wall Height is 88"
- Window Ledge Height is 40"
- Truss sits one log lower than wall height

Popular Options:

- Double Doors \$1,200
 - Extra Layer of Logs \$700
 - 6' Loft \$800 (Extra Layer of Logs recommended)
 - Additional Door or Window \$500/each
 - Extra Truss \$300
 - Add Electrical Package \$2,000. Includes 5 outlets, 110V Breaker Box, 4 Lights & 1 Switch
 - Each additional 110V - \$150
 - Each additional Light - \$150
 - 220 V Outlet - \$250
- Interior Finish Out Options Available. Call for Pricing!

CHINK STYLE



SIZE	CASH PRICE	Same Price for D Style and Chink Style	
10x20	\$17,900	14x30	\$24,200
12x30	\$22,000	14x36	\$28,700
12x36	\$24,700	14x42	\$30,600
14x20	\$18,500		

See page 3 for Rent-To-Own options



Most Popular Stain Options:



Natural Cedar



Roasted Almond



Weathered Wood

View all stain color options available at www.sansin.com



Chink Style



D Style

ELK CREEK SERIES

The Elk Creek Series is unique in its own way. This cabin features trapezoidal windows on the front and back walls, which offer a bright and welcoming appearance.

SIZE	CASH PRICE
12x24	\$25,600

See page 3 for
Rent-To-Own options
12x36 \$30,400

PIKES PEAK SERIES

Introducing the Pikes Peak Series, a timeless A-Frame Cabin that harks back to the golden days of park and campground retreats. This charming style, once a beloved staple of outdoor adventures, is now beautifully reimagined for your personal enjoyment. Choose from three distinct sizes and bring a touch of nostalgic rustic charm to your modern life.

SIZE	CASH PRICE
14x20	\$20,000
14x30	\$21,300
14x40	\$24,300

See page 3 for
Rent-To-Own options

RIVERS EDGE SERIES

Our largest log cabins are perfect for a lodge, group getaway, or even a permanent home. With their spacious design and authentic charm, these cabins provide the ideal setting for creating lasting memories, whether for a weekend retreat or everyday living.

Popular Options:

- Same as D and Chink Style



INTERIOR UNFINISHED

SIZE	CASH PRICE	See page 3 for Rent-To-Own options
24x24	\$36,800	28x24 \$38,700
24x30	\$41,300	28x30 \$43,300
24x36	\$45,900	28x36 \$47,950
24x40	\$49,000	28x40 \$51,100

BEAVER LODGE SERIES

The Harmony Structures Beaver Lodge Series features a Rampage Door for convenient drive-in access for UTVs and other vehicles. Additionally, it includes a side entry porch, enhancing its accessibility and functionality. Crafted in a D-style log cabin design, this cabin combines rustic charm with practical versatility, making it perfect for both recreational and practical uses.

Popular Options:

- Same as D and Chink Style



RAMPAGE DOOR



RAMP W/ LOG CABIN

SIZE	CASH PRICE	See page 3 for Rent-To-Own options
14x36	\$33,600	14x42 \$40,400

STUDIO CABINS

The Studio Cabin by Harmony Structures features a sleek one-slope roof, adding a modern flair to your studio cabin or office. Add transom windows to bring in extra light, while the roof overhang provides a finished touch and protects windows and doors from the elements. Perfect for a stylish and functional workspace or retreat.

Features Include:

- ☐ 93.5" sidewalls
- ☐ 1 – 36" 9 lite insulated door
- ☐ Up to 30': 3 – 2'x3' windows
- ☐ 14' & 16' wide x 20' – 30' long:
4 – 2'x3' windows
- ☐ 32' and longer: 6 – 2'x3' windows
- ☐ Overhangs
(16' wide do not have overhangs)
- ☐ See page 20 for more options



SIZE CASH PRICE See page 3 for Rent-To-Own options

10x16	\$6,210	12x36	\$14,240	16x32	\$13,920
10x18	\$6,715	14x20	\$11,005	16x36	\$15,345
10x20	\$7,120	14x24	\$12,525	16x40	\$16,320
12x14	\$6,860	14x28	\$13,090	16x44	\$17,420
12x16	\$7,490	14x32	\$14,210	16x48	\$18,420
12x18	\$8,115	14x36	\$15,755	16x50	\$19,020
12x20	\$8,580	14x40	\$17,130	16x52	\$19,820
12x24	\$9,710	16x20	\$9,295	16x54	\$20,420
12x28	\$10,900	16x24	\$11,070	16x56	\$21,170
12x30	\$11,565	16x28	\$12,420	16x58	\$21,930
12x32	\$12,830	16x30	\$12,970	16x60	\$22,670

See page 7 for Interior Finished options

POPULAR OPTIONAL CONFIGURATIONS:

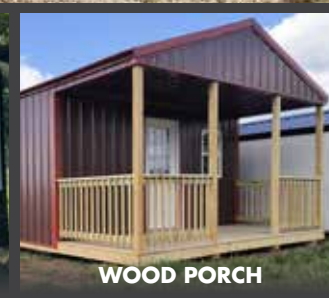

DOUBLE WIDE GARAGE



Looking for a His & Hers garage or just need space for all your vehicles? Explore our double wide options. Our garage floors are built to support 1-ton trucks.

Features Include:

- 2 – 2" x 3" windows
- 1 – 36" entry door with 9 lite
- Floor joists on 12" centers
- 3/4" Advantech Floor
- 24' & 28' wide include 2 – 9' x 7' insulated doors
- 32' wide include 2 – 10' x 7'6" insulated doors
- See page 20 for more options

SIZE	CASH PRICE
24x24	\$18,775
24x30	\$20,750
24x36	\$23,530
24x40	\$25,920
28x32	\$23,825
28x36	\$26,863
28x40	\$29,900
32x36	\$27,400
32x40	\$32,900
32x48	\$39,745
32x50	\$41,297
32x52	\$42,852

See page 3 for Rent-To-Own options

DOUBLE WIDE CABIN



Looking for a new home? Discover the Harmony Structures Double Wide Cabin. Combining the convenience of prebuilt construction with on-site quality, our double wides offer unbeatable value. Choose from endless interior options, including vaulted or standard ceilings, customizable plumbing and electrical setups, and floor plans tailored to your dreams.

Features Include:

- 6 – 2'x3' vinyl insulated windows
- 2 – 36" 9 lite insulated doors
- 93.5" sidewalls

SIZE	CASH PRICE	See page 3 for Rent-To-Own options
20x24	\$12,970	28x36 \$24,862
20x32	\$16,600	28x40 \$27,900
24x24	\$16,775	32x36 \$25,000
24x30	\$18,750	32x40 \$30,500
24x36	\$21,530	32x48 \$37,345
24x40	\$23,920	32x50 \$38,897
28x32	\$21,825	32x52 \$40,452

LOFTED GARAGE



Looking for a portable garage but need some additional space? Adding a gambrel roof to your garage opens up your overhead space allowing a loft to fit your needs.

Features Include:

- 81.5" sidewalls
- Floor joists on 12" centers
- 2 - 24"x36" windows
- 1 - 36" entry door with 9 lite
- 12' - 14' wide have 9' x 7' insulated door
- 16' wide has 10' x 7'6" insulated door
- 3/4" Advantech Floor
- See page 20 for more options



RATED FOR 1-TON TRUCKS



INTERIOR LOFT

SIZE CASH PRICE

12x16	\$8,100	14x28	\$13,251	16x44	\$19,825
12x18	\$8,733	14x32	\$14,669	16x48	\$21,000
12x20	\$9,390	14x36	\$15,390	16x50	\$21,700
12x24	\$10,709	14x40	\$16,395	16x52	\$22,590
12x28	\$11,583	16x24	\$12,980	16x54	\$23,280
12x30	\$12,005	16x28	\$14,100	16x56	\$24,140
12x32	\$12,507	16x30	\$14,915	16x58	\$25,000
12x36	\$13,830	16x32	\$15,780	16x60	\$25,860
14x20	\$11,195	16x36	\$13,385		
14x24	\$12,243	16x40	\$18,545		

See page 3 for Rent-To-Own options

A-FRAME GARAGE



RATED FOR 1-TON TRUCKS

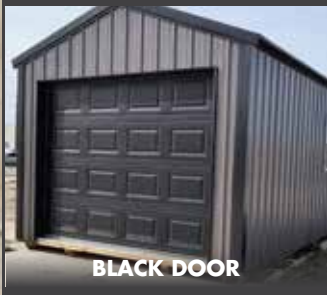

BLACK DOOR



INTERIOR UNFINISHED

Extending the life of those expensive toys to protecting your vehicles from the weather, we've got the portable garage for you. Plus you'll love our real garage doors. These are not roll up doors! Dare to compare!

Features Include:

- 93" walls
- Floor joists on 12" centers
- 2 - 24"x36" windows
- 1 - 36" entry door with 9 lite
- 12' - 14' wide have 9' x 7' insulated door
- 16' wide has 10' x 7'6" insulated door
- 3/4" Advantech Floor
- See page 20 for more options

SIZE CASH PRICE

12x16	\$7,160	12x32	\$11,425	14x36	\$14,185	16x32	\$14,650	16x52	\$20,800
12x18	\$7,730	12x36	\$12,710	14x40	\$15,450	16x36	\$16,130	16x54	\$21,420
12x20	\$8,130	14x20	\$10,080	16x20	\$10,060	16x40	\$17,150	16x56	\$22,210
12x24	\$9,140	14x24	\$10,995	16x24	\$11,710	16x44	\$18,300	16x58	\$23,000
12x28	\$10,215	14x28	\$11,935	16x28	\$13,100	16x48	\$19,350	16x60	\$23,800
12x30	\$10,820	14x32	\$12,760	16x30	\$13,850	16x50	\$19,970		

See page 3 for Rent-To-Own options

UTILITY SHEDS

Discover Harmony Structures' versatile utility shed, available in durable metal or classic wood. Perfect for storing tools, lawn equipment, and seasonal items, this stylish shed offers ample space and reliable protection.

Features Include:

- 8' & 10' wide have 76.5" walls
- 12' & 16' wide have 93.5" walls
- 6' double door except
- 8' wide has 54" single door
- See page 20 for more options



SIZE	CASH PRICE	See page 3 for Rent-To-Own options					
8x10	\$2,600	12x16	\$5,450	14x32	\$10,850	16x36	\$13,825
8x12	\$2,825	12x18	\$5,995	14x36	\$12,225	16x40	\$14,800
8x14	\$3,120	12x20	\$6,380	14x40	\$13,450	16x44	\$15,900
8x16	\$3,410	12x24	\$7,350	16x20	\$7,950	16x48	\$16,900
10x12	\$3,520	12x28	\$8,380	16x24	\$9,550	16x50	\$17,500
10x14	\$4,070	12x30	\$8,965	16x28	\$10,900	16x52	\$18,300
10x16	\$4,250	12x32	\$9,550	16x30	\$11,625	16x54	\$18,900
10x18	\$4,675	14x20	\$8,300	16x32	\$12,400		
10x20	\$5,000	14x24	\$9,180				
12x14	\$4,900	14x28	\$10,065				



GARDEN SHEDS

Transform your garden with Harmony Structures Garden Shed, featuring a central swinging door, and optional shutters and flower boxes. Functional and stylish, it's perfect for organizing your tools.

Features Include:

- 8' & 10' wide have 76.5" walls
- 12' & 16' wide have 93.5" walls
- Includes 2 - 2'x3' windows
- 6' double door except
- 8' wide has 54" single door
- See page 20 for more options

OPTIONAL CONFIGURATIONS:

SIZE	CASH PRICE	See page 3 for Rent-To-Own options							
8x10	\$2,800	10x20	\$5,200	12x32	\$9,750	14x40	\$13,650	16x44	\$16,100
8x12	\$3,025	12x14	\$5,100	12x36	\$11,000	16x20	\$8,150	16x48	\$17,100
8x14	\$3,320	12x16	\$5,650	14x16	\$6,850	16x24	\$9,750	16x50	\$17,700
8x16	\$3,610	12x18	\$6,295	14x20	\$8,500	16x28	\$11,100	16x52	\$18,500
10x12	\$3,720	12x20	\$6,580	14x24	\$9,380	16x30	\$11,825	16x54	\$19,100
10x14	\$4,270	12x24	\$7,550	14x28	\$10,265	16x32	\$12,600		
10x16	\$4,450	12x28	\$8,580	14x32	\$11,050	16x36	\$14,025		
10x18	\$4,875	12x30	\$9,265	14x36	\$12,425	16x40	\$15,000		



Window Boxes

Shutters

LOFTED BARN

The Lofted Barn from Harmony Structures provides extra storage with its loft, offering ample room for your mower and garden tools without needing a larger building.

Features Include:

- All sizes have 76.5" walls
- Includes full loft except for access area
- 6' double door except
- 8' wide has single 54" door
- See page 20 for more options

SIZE	CASH PRICE
------	------------

10x12	\$4,150
10x14	\$4,540
10x16	\$4,920
10x18	\$5,320
10x20	\$5,720
12x14	\$5,660
12x16	\$6,380
12x18	\$7,000
12x20	\$7,645

See page 3 for Rent-To-Own options

12x24	\$8,940
12x28	\$9,790
12x30	\$10,200
12x32	\$10,690
12x36	\$11,990
14x20	\$9,430
14x24	\$10,450
14x28	\$11,430
14x32	\$12,820

14x36	\$13,510
14x40	\$14,490
16x24	\$10,870
16x28	\$11,950
16x30	\$12,750
16x32	\$13,600
16x36	\$15,175
16x40	\$16,300
16x44	\$17,550

16x48	\$18,700
16x50	\$19,375
16x52	\$20,250
16x54	\$20,925
16x56	\$21,700
16x58	\$22,470
16x60	\$23,250

LOFTED GARDEN SHED

Maximize your storage with Harmony Structures' Lofted Garden Shed. Featuring additional loft space, it's perfect for organizing outdoor equipment and seasonal items.

Features Include:

- All sizes have 76.5" walls
- Includes full loft except for access area
- Includes 2 - 2'x3' windows
- 6' double door except
- 8' wide has single 54" door
- See page 20 for more options

SIZE	CASH PRICE
------	------------

10x12	\$4,350
10x14	\$4,740
10x16	\$5,120
10x18	\$5,520
10x20	\$5,920
12x14	\$5,860
12x16	\$6,580
12x18	\$7,200
12x20	\$7,845

See page 3 for Rent-To-Own options

12x24	\$8,940
12x28	\$9,990
12x30	\$10,400
12x32	\$10,890
12x36	\$12,190
14x20	\$9,630
14x24	\$10,650
14x28	\$11,630
14x32	\$13,020

14x36	\$13,710
14x40	\$14,690
16x24	\$11,070
16x28	\$12,150
16x30	\$12,950
16x32	\$13,800
16x36	\$15,375
16x40	\$16,300
16x44	\$17,750

16x48	\$18,900
16x50	\$19,575
16x52	\$20,450
16x54	\$21,125
16x56	\$21,900
16x58	\$22,670
16x60	\$23,450



INTERIOR LOFT

GREENHOUSES

The Greenhouse from Harmony Structures is perfect for starting early in the spring or extending your fall harvest. Ideal for the home gardener.

Features Include:

- 1 – 36" door with glass and screen
- 10' long have 3 – 24"x36" windows
- 12', 14', 16' long have 5 – 24"x36" windows
- 18', 20', 22' long have 7 – 24"x36" windows
- 24', 26', 28' long have 9 – 24"x36" windows
- 30', 32', 34' long have 11 – 24"x36" windows
- 36', 38', 40' long have 13 – 24"x36" windows
- 1 – 19" exhaust fan with thermostat
- 8mm poly carbinat roof and side walls
- 77" sidewalls
- All treated lumber

Floors are available

- Composite add \$10 sq.ft.
- Treated wood add \$6 sq.ft.
- See page 20 for more options

NOTE: A level pad is recommended.



Multiple Color Options

OPTIONAL CONFIGURATION:



Interior with Shelving

SIZE	CASH PRICE	See page 3 for Rent-To-Own options	
8x10	\$3,500	8x20	\$5,600
8x12	\$3,850	12x14	\$5,800
8x14	\$4,150	12x16	\$6,000
8x16	\$4,500	12x20	\$6,500
8x18	\$5,100	12x24	\$7,200
		12x28	\$8,000
		12x30	\$8,600
		12x32	\$9,200
		12x36	\$10,000
		12x40	\$11,000

Bring It Home with Simple and Affordable Rent-To-Own Solutions

ECONOMY BUILDINGS

Need storage space on a limited budget? Our economy buildings offer well-trimmed, sturdy, and vented solutions that won't disappoint. Affordable and reliable, they will meet or exceed your storage needs.

SIZE	CASH PRICE	SIZE	CASH PRICE
8x12	\$2,402	10x24	\$5,100
8x15	\$2,898	12x16	\$4,633
10x16	\$3,612	12x20	\$5,423
10x20	\$4,250	12x24	\$6,247

- See page 20 for more options
- See page 3 for Rent-To-Own options



Unfinished Interior

ANIMAL SHELTERS

The Animal Shelter from Harmony Structures is perfect for housing animals or storing small equipment. Durable and versatile, it meets all your needs.

Features Include:

- Interior lined with 1" kick boards
- 4x6 treated perimeter
- Tack rooms can be added for \$6 per sq.ft.
- 1 side open
- No floor
- See page 20 for more options

SIZE	CASH PRICE	See page 3 for Rent-To-Own options			
10x16	\$3,760	12x30	\$7,685	16x24	\$7,975
10x18	\$4,110	12x32	\$8,185	16x28	\$9,210
10x20	\$4,285	12x36	\$9,190	16x30	\$9,975
12x14	\$4,200	14x20	\$7,110	16x32	\$10,545
12x16	\$4,715	14x24	\$7,825	16x36	\$11,355
12x18	\$5,140	14x28	\$8,625	16x40	\$12,620
12x20	\$5,475	14x32	\$9,325	16x44	\$13,575
12x24	\$6,300	14x36	\$10,470	16x48	\$14,525
12x28	\$7,180	14x40	\$11,610		



CUSTOM OPTIONS

These options can be added to any building. Additional customizations are available upon request. If you can dream it, we can build it.

OPTIONS

- Porch w/Composite Decking
- Porch w/Wood Decking
- Rustic Porch
- Deluxe Porch
- Vinyl Railing
- Wood Railing
- Door Dead Bolt
- Blank French Door
- French Door
- 36" Residential Entrance Door Blank
- 36" Residential Entrance Door w/9 Lite Window
- 9'x7' Insulated Garage Door Black or White
- 10'x7.5' Insulated Garage Door
- Shed Door per each
- Patio Door
- Add Window with Internal Blinds (to any door)
- Aluminum Garage Ramps (Set of 2 - 2'x4')
- Aluminum Utility Ramps (Set of 2 - 2'x4')
- Wood Utility Ramps (Set of 2 - 2'x4')
- Economy Electrical Package - 1 Outlet, 1 Switch, 1 Light
- Deluxe Electric Package - 100 Amp Panel, 4 Outlets, 2 Lights, 1 Switch
- Electrical - Each Additional 110V Opening (Switch, Outlet, Light)
- Electrical - Each Additional 220V Opening (Drier Plug, A/C Plug)
- Green House Exhaust Fan
- Green House Door
- Green House Shelving
- 3'x3' Vinyl Insulated Window
- 3'x5' Vinyl Insulated Window
- 24"x36" Window w/Screen
- Twin 24"x36" Window
- Twin 36"x48" Window
- 24"x36" Vinyl Insulated Window
- 36"x48" Vinyl Insulated Window
- 12"x36" Transom Window
- Shutters Per Set
- Flower Box

COST

- \$15.25 per sq. ft.
- \$9.00 per sq. ft.
- \$30 per sq. ft.
- \$54.00 per sq. ft.
- \$46.00 per ln. ft.
- \$10.00 per ln. ft.
- \$50.00
- \$1,100.00
- \$1,500.00
- \$400.00
- \$450.00
- \$1,100.00
- \$1,400.00
- \$125.00
- \$1,200.00
- \$300.00
- \$590.00
- \$325.00
- \$155.00
- \$250.00
- \$750.00
- \$100.00
- \$200.00
- \$350.00
- \$280.00
- \$7.50 per sq. ft.
- \$300.00
- \$385.00
- \$100.00
- \$385.00
- \$650.00
- \$200.00
- \$350.00
- \$230.00
- \$40.00
- \$40.00



Composite Porch with Vinyl Railing



Wood Porch with Wood Railing



Shed Doors

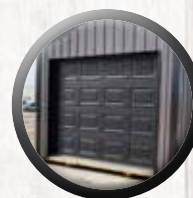

Insulated Garage Door Black



Green House Door



Blank Door



9 Lite Door



Insulated Garage Door White



French Door



Patio Door



36x48 Window



36x48 Twin Window



AC Unit



Exhaust Fan



Green House Shelving



12" Overhangs



Rustic Porch



Deluxe Porch



Roof Dormer

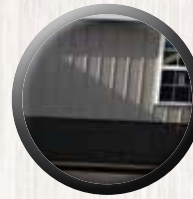

Wainscoting



All Colors Meet Energy Star Requirements
All Colors Carry A 40-Year Limited Paint Warranty
Copper Metallic Can Vary Slightly Between Orders
Actual Colors Can Vary Slightly From This Chart

SHERWIN-WILLIAMS
Coil Coatings

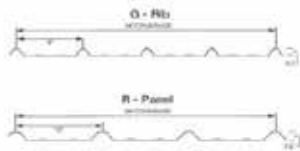

NaturalKote Semi-Transparent Wood Stains
Close Image to Enlarge

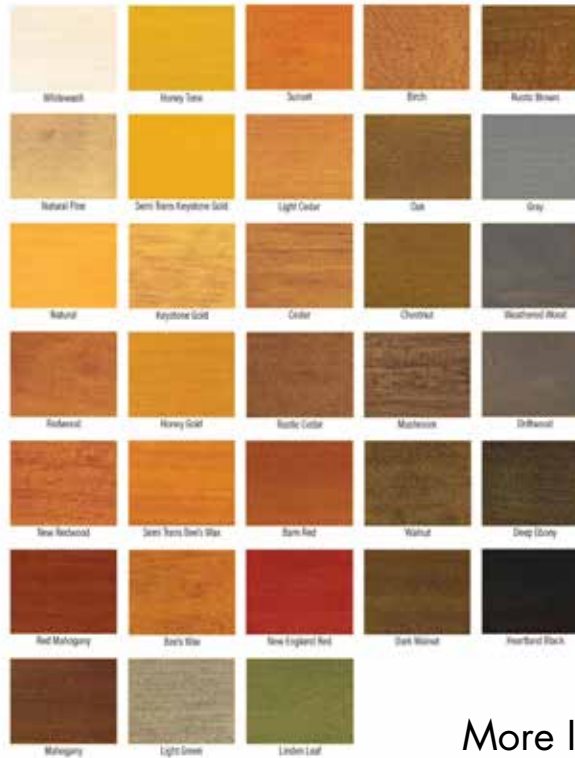

PAINT & STAIN OPTIONS

Discover a wide range of custom paint options for painted buildings at www.sherwin-williams.com. We can match any color you provide at no extra cost, ensuring your new building gets the perfect shade. All displayed stain colors are approximations of the actual shades. Lighting, texture, wood grain porosity, wood species, and the condition of previously stained surfaces can all affect the final color.

More Insulation Options Available.
Call for Details.

CUSTOM OPTIONS CONT.

- 12" Overhang On Any Building \$20.00 per running ft.
- Wainscoting (28" Tall) \$1.50 per sq. ft.
- Roof Dormer \$3,500.00
- A/C Unit 14000BTU Through Wall \$1200.00
- Taller Walls Upgrade \$1.40 per sq. ft.
- Vapor Barrier in Walls \$0.60 per sq. ft.
- Frame Out Interior Walls – Per Running Foot \$20.00

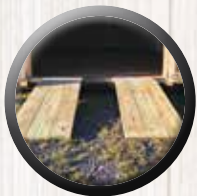

Wood Utility Ramp



Aluminum Utility Ramp



Aluminum Garage Ramp



12"x36" Transom Window

Closed Cell Foam Pricing						
	1.5" On Walls & Roof (A Frame)	1" On Floor	Total	1.5" On Walls & Roof (Lofted)	1" On Floor	Total
12x16	\$1,400	\$282	\$1,682			
12x18	\$1,521	\$320	\$1,841	\$1,570	\$282	\$1,852
12x20	\$1,636	\$356	\$1,992	\$1,697	\$320	\$2,017
12x24	\$1,873	\$427	\$2,300	\$1,823	\$356	\$2,179
12x28	\$2,109	\$499	\$2,608	\$2,072	\$427	\$2,499
12x30	\$2,227	\$534	\$2,761	\$2,330	\$499	\$2,829
12x32	\$2,343	\$570	\$2,913	\$2,456	\$534	\$2,990
16x24	\$2,227	\$570	\$2,797	\$2,583	\$570	\$3,153
16x30	\$2,633	\$713	\$3,346	\$2,894	\$713	\$3,607
16x32	\$2,696	\$761	\$3,457	\$2,964	\$761	\$3,725
16x36	\$3,036	\$855	\$3,891	\$3,323	\$855	\$4,178
16x40	\$3,311	\$951	\$4,262	\$3,614	\$951	\$4,565
16x48	\$3,848	\$1,141	\$4,989	\$4,185	\$1,141	\$5,326
16x54	\$4,251	\$1,283	\$5,534	\$4,615	\$1,283	\$5,898
24x24	\$3,131	\$860	\$3,991			
28x32	\$4,269	\$1,331	\$5,600			
28x40	\$5,011	\$1,664	\$6,675			
32x36	\$5,129	\$1,710	\$6,839			
32x40	\$5,535	\$1,901	\$7,436			
32x48	\$6,343	\$2,281	\$8,624			
32x52	\$6,749	\$2,471	\$9,220			

1" \$1.49 sqft enter sq ft \$0.00

1.5" \$2.30 sqft \$0.00

2" \$3.00 sqft \$0.00

SIDE PORCH & PAVILIONS

Enhance your Harmony Structures building with our stylish side porches and pavilion-style porches, crafted from treated wood for lasting durability. These versatile additions not only increase your outdoor living space but also add a touch of elegance to any structure. Ideal for relaxing, entertaining, or providing sheltered entryways, our porches combine functionality and aesthetic appeal, making them the perfect upgrade for your home. Transform your outdoor experience with Harmony Structures' premium porches.

Features Include:

- Treated wood where exposed to weather
- Metal roof
- Wood railing with 5' opening
- Pavilion has opening on both sides

Popular Options:

- Composite floor
- Vinyl covered posts
- Vinyl railing



SIZE	CASH PRICE	SIDE PORCH	
6x12	\$2,300	8x16 \$3,100	10x20 \$4,500
6x16	\$3,070	8x20 \$3,820	10x24 \$5,400
8x10	\$2,340	10x12 \$3,200	
8x12	\$2,570	10x16 \$3,865	

SIZE	CASH PRICE	PAVILIONS		
8x10	\$2,340	10x24 \$5,400	14x36 \$11,000	
8x12	\$2,570	12x20 \$5,740	16x24 \$8,595	
8x16	\$3,100	12x24 \$6,615	16x32 \$11,160	
10x12	\$3,200	12x32 \$8,595	16x36 \$12,440	
10x16	\$3,865	14x24 \$8,260	16x40 \$13,320	
10x20	\$4,500	14x32 \$9,765	16x48 \$15,210	

BUILDING DELIVERY

At Harmony Structures, we pride ourselves on providing exceptional service, starting with our hassle-free delivery options. Enjoy free delivery within 100 miles from our factory in Dunnegan, MO, and within 50 miles from any of our dealer locations.

Need your building delivered farther? No problem! We offer state-wide delivery and beyond for a nominal fee. Our rates are competitive and straightforward:

\$4.50 per mile for buildings up to 12'
\$8.50 per mile for buildings 14' and 16'

Whether you're near or far, Harmony Structures ensures your building arrives safely and promptly. Trust us to deliver excellence right to your doorstep.

ACTUAL SIZE OF BUILDINGS

A 16' building measures 15'3" at the bottom and up to 16' at eaves
A 14' building measures 14' at the bottom and up to 15' at eaves
A 12' building measures 11'4" at the bottom and up to 12' at eaves
A 10' building measures 10' at the bottom and up to 11' at eaves
An 8' building measures 8' at the bottom and up to 9' at eaves

PAD & BLOCKING

- We recommend a level gravel or concrete pad
- If the building is not set on a concrete pad, some settling may occur.
(We are not responsible if settling occurs.)
- Tie downs are recommended.
- Harmony Structures does not install tie downs.
- We are not responsible for tracks or ruts left in your yard after delivery.
- We have concrete blocks available at \$4.00 each.
- We can also use your blocks if close to building site.
- Blocking is needed every 8' per runner.



Cabins built by Harmony Structures at Mountain Creek Family Resort on the Niangua River.

Contact your local sales rep:

Prices Subject to change. Prices Current as of August 2024.